











# CROWNE PLAZA LEEDS

## Meetings & Events Fact Sheet

Close to the city centre and motorway links. Crowne Plaza Leeds has seven impressive meeting rooms and can cater for everything from an intimate business gathering to a conference for 200. With climate control and free WiFi throughout, guests can also enjoy fresh coffee in the large breakout area, or on the terrace outside.



-  No. of bedrooms  
135
-  54 twin rooms  
available
-  Gym
-  Pool
-  102 parking spaces on-site  
£17.50 24 hrs Sun-Thur  
£15.00 24 hrs Fri-Sat
-  4 electric  
charging points
-  Leeds Station  
(0.4 miles)
-  Leeds Bradford  
(8.1 miles)
-  7 meeting  
rooms
-  Air conditioning in  
all M&E rooms
-  Outdoor dining  
capacity of 20

	Dimensions (sq ft)	Classroom	Theatre	Boardroom	Cabaret	Banqueting
<b>GROUND</b>						
Executive Boardroom	238.4	N/A	N/A	12	N/A	12
Gledhow Room	240.4	12	20	15	N/A	15
Headingley Suite	1,064	36	70	30	42	60
Kirkstall Room	236	12	20	15	N/A	15
Roundhay Suite	2,216.1	90	200	60	105	150
Roundhay Suite 1	1,078.5	48	70	40	56	60
Roundhay Suite 2	584.6	24	40	26	24	30
Roundhay Suite 3	586.8	24	40	26	24	30
Roundhay 1&2	1,645	66	150	50	72	80
Roundhay 2&3	1,161.6	48	70	40	48	60

# FLOOR PLAN

Executive Boardroom

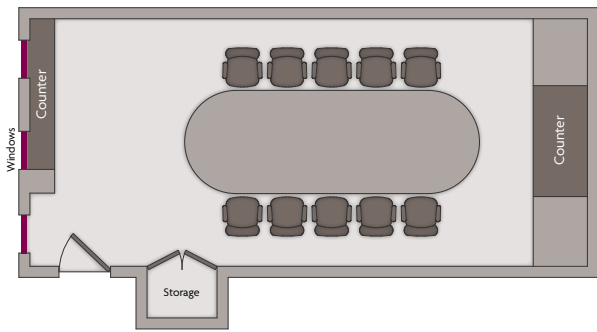

Gledhow

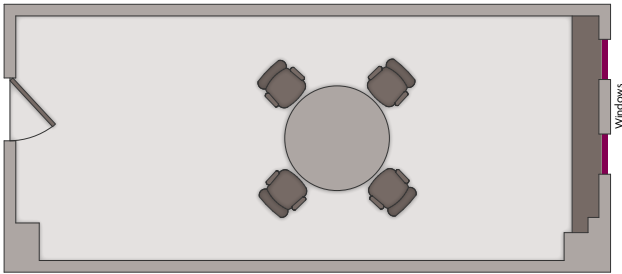

Headingley Suite

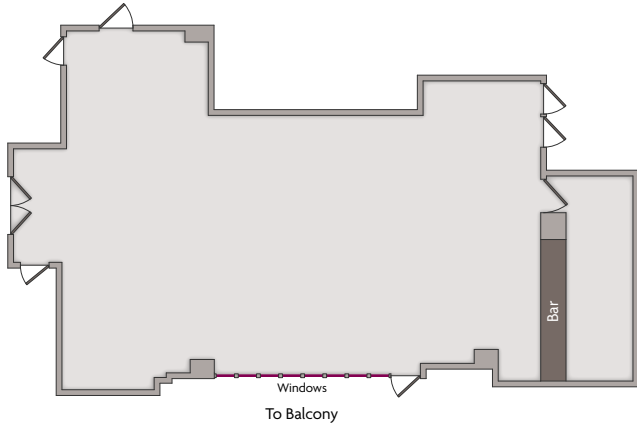

Kirkstall

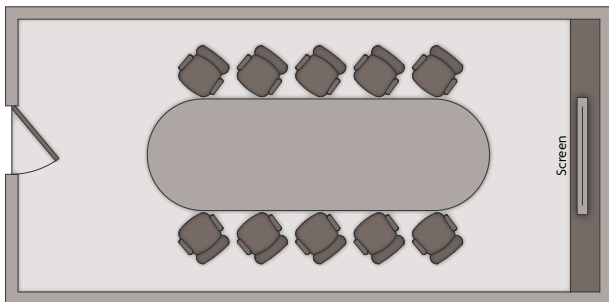

Roundhay Suite 1

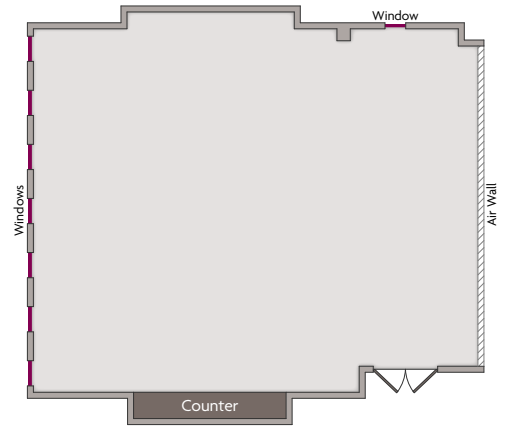

Roundhay Suite 2

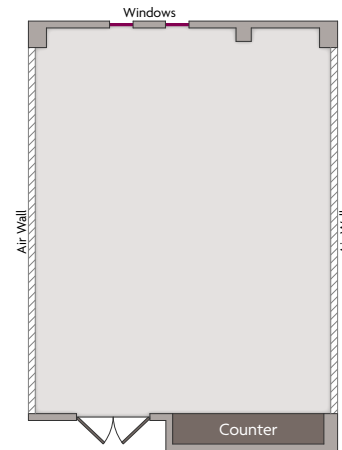

Roundhay Suite 3

