

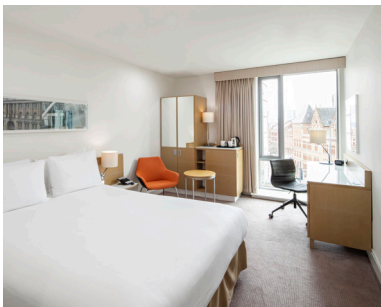









DoubleTree by Hilton Manchester

Meetings & Events Fact Sheet

Located in the city centre and a stones throw away from Piccadilly Station, our hotel specialises in meeting and events for up to 200 people. With 15 private spaces and a spacious breakout area where delegates can enjoy a selection of food and beverage packages.

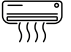

-  No. of bedrooms 285
-  90 twin rooms available
-  Gym
-  Manchester Piccadilly Station (0.1 mile)
-  10 parking spaces on-site £24.00
-  2 charging points
-  Manchester International (9 miles)
-  15 meeting rooms
-  Air conditioning in all M&E rooms
-  Natural daylight in all M&E rooms
-  Outdoor dining capacity of 80

	Dimensions (m)	Classroom	Theatre	Boardroom	Cabaret	Reception
Atholl	7.6 x 6.6	18	32	18	16	50
Linlithgow	10 x 6.6	32	60	28	32	70
Scone	10.4 x 4.2	20	50	18	24	60
Atholl & Linlithgow	17.6 x 6.6	50	120	50	70	130
Linlithgow & Scone	20.4 x 4.2/6.6	50	100	50	60	140
Palaces	28 x 6.4/6	72	170	60	100	200
Brodick	6.6 x 6.5	18	28	16	16	40
Cawdor	7.2 x 6.5	18	40	18	16	45
Brodick & Cawdor	13.8 x 6.5	42	77	34	40	90
Balmoral	6.1 x 3.1	0	10	8	0	20
Inverary	6.1 x 3.2	0	10	8	0	20
Borthwick	6.1 x 3.1	0	10	8	0	20
Holyrood	6.1 x 3.2	0	10	8	0	20
Inverary & Balmoral	6.1 x 6.3	18	36	16	16	40
Holyrood to Borthwick	6.1 x 6.3	18	36	16	16	40
Inverary to Holyrood	8.5 x 6.1	22	50	22	24	50
Inverary to Borthwick	11.2 x 6.1	36	70	30	40	75
Barony	5.6 x 6.7	18	40	16	16	35
Glamis	5.6 x 6.1	18	26	14	16	30
Barony & Glamis	11.2 x 6.1	36	70	30	40	75
Dunstaffnage	5.6 x 3.7	10	10	8	0	18
Drum	4.0 x 3.4	N/A	10	6	0	8
Dunrobin	4.0 x 3.4	N/A	10	6	0	8
Sky Lounge	10.1 x 8.1	24	50	20	32	60

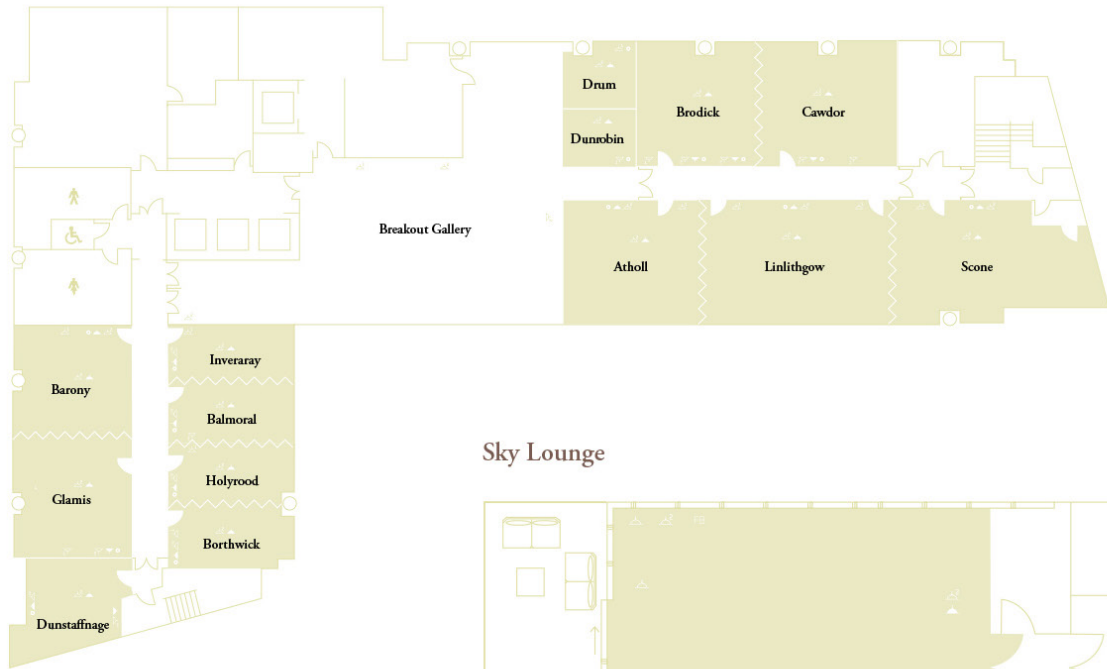

Sky Lounge

