









CROWNE PLAZA STRATFORD UPON AVON

Meetings & Events Fact Sheet

This business friendly hotel located in the heart of the town has 14 contemporary meeting rooms to offer. With free Wi-Fi and on-site car parking, our flexible event spaces can cater for any size meeting, event or conference from 10 to 550 people with a dedicated Crowne Plaza Meetings Director on-site, a conference café and food and drink options to match your requirements. Overlook the River Avon from the Riverside Terrace the perfect space for outdoor events such as BBQ and team building.



-  No. of bedrooms 259
-  64 twin rooms available
-  Gym
-  Pool
-  350 parking spaces on-site £10.00
-  4 charging points
-  Stratford-upon-Avon Station (1 mile)
-  Birmingham (27 miles)
-  14 meeting rooms
-  Air conditioning in all M&E rooms
-  Outdoor dining capacity of 140

	Dimensions	Classroom	Theatre	Boardroom	Cabaret	Banquet
ROOMS	LxW					
Grand Ballroom	37.6x14.8 556 ms ²	340	550	N/A	360	500
Ballroom ABC	21.5x14.8 318.2 ms ²	260	360	N/A	200	300
Ballroom AB	8x14.8 118.4 ms ²	120	200	60	120	200
Ballroom CD	23.1x14.8 341.88 ms ²	80	180	N/A	200	300
Ballroom C	7x14.8 103.6 ms ²	50	100	40	64	100
Ballroom D	16.1x14.8 238.28 ms ²	60	100	N/A	96	200
Charlecote/Harewood	14.8x14.4 213.12 ms ²	100	140	N/A	96	200
Charlecote	14.8x6.7 99.16 ms ²	50	100	36	64	80
Harewood	14.8x6.7 99.16 ms ²	50	100	36	64	80
Blenheim	14.8x6.7 99.16 ms ²	50	100	36	64	80
Packwood	14.8x6.7 99.16 ms ²	50	100	36	64	80
Warwick	11x8 88 ms ²	40	60	32	40	60
Meeting Syndicate 1	6.3x5 31.5 ms ²	12	20	14	N/A	N/A
Meeting Syndicate 2	6.2x5 31 ms ²	12	20	14	N/A	N/A
Hidcote	12x7.5 90 ms ²	40	60	32	40	N/A
Hatton	5x5 25 ms ²	9	20	12	N/A	N/A
Boardroom	7x4 28 ms ²	9	20	12	N/A	N/A
Bancroft	5.5x5 27.5 ms ²	9	20	12	N/A	N/A
Seymour	14.6x14.6 213.16 ms ²	N/A	N/A	N/A	N/A	100

FLOOR PLAN

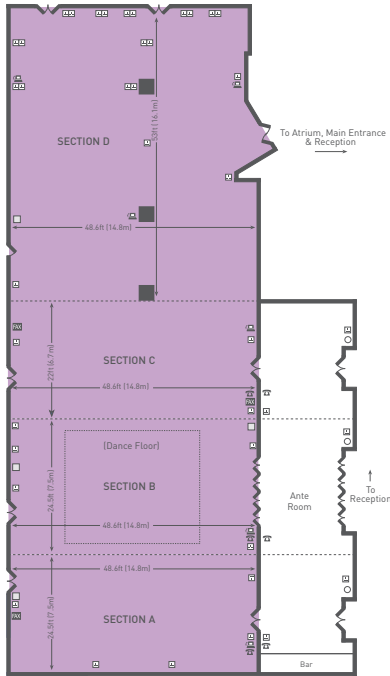

Ballroom

Section A, B, C & D combined

Avon Meeting Rooms



East Wing Meeting Rooms



Key

- Single 13 amp socket
- Double 13 amp socket
- Telephone point

- Television point
- 3 Phase electricity supply
- Controllable lighting

- Moveable partition
- Column